



HOME-R HOUSEBOAT



MODERN
WATER
RECREATION





LOBBECK
BOATWORKS



CHOOSE WHERE...



MEASUREMENTS

FLOATS + PLATFORM CABIN ROOF RAILINGS

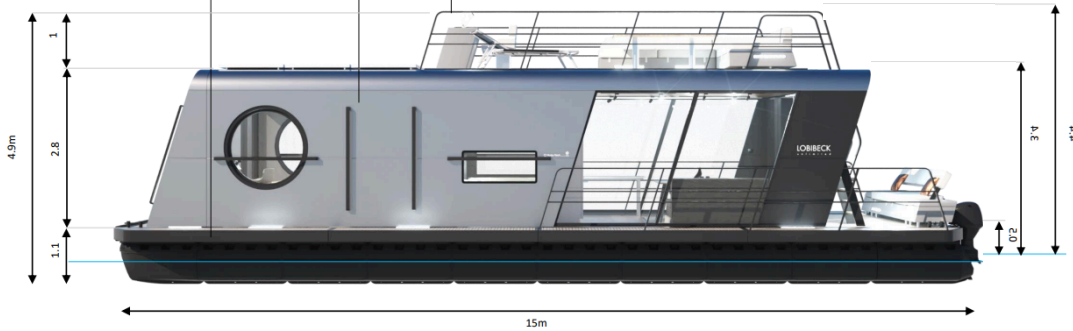

LEFT SIDE VIEW
/ OVERALL DIMENSIONS
/ HEIGHT FROM
THE WATER LEVEL

FRONT AND BACK VIEW
/ OVERALL DIMENSIONS

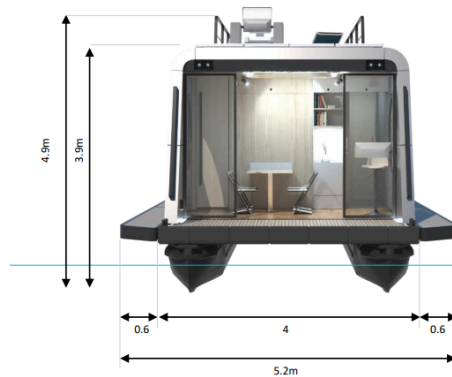

WATER LEVEL



WHY SHOULD YOU CHOOSE A HOME-R HOUSEBOAT?

BECAUSE IT MEANS FREEDOM.
INNOVATIVENESS.
LUXURY.
INDEPENDENCE.
BEAUTY.

IT MEANS WHATEVER YOU WANT IT
TO MEAN.

WITH HOME-R, YOU ARE TRAVELLING
ON YOUR OWN TERMS.

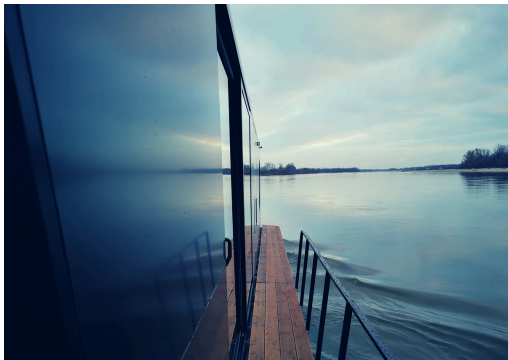

WITH **HOME-R**, YOU ARE TRAVELLING ON **YOUR OWN TERMS**.
HOME-R IS AN **IDEA**, IT IS AN **ADVENTURE**, IT IS A **DREAM**.
OUR BOAT WILL TAKE YOU TO INTERESTING, MAYBE WILD AND
SECLUDED PLACES, BUT YOU WILL ALWAYS HAVE YOUR HOME
WITH YOU EVERYWHERE YOU GO.

EVERYTHING IS DESIGNED FOR A COMFORTABLE LIFE ON
WATER, WITH ATTENTION TO THE SMALLEST DETAILS, SO AS TO
CREATE A LUXURIOUS APARTMENT SUITABLE FOR A YEAR-
ROUND LIVING, UP TO SIX PEOPLE.

- / TOTAL SURFACE 69 M2
- / AN AREA WITHOUT HALF-DECKS 60 M2
- / AN AREA OF THE RESIDENTIAL PART 52 M2
- / A USABLE AREA OF THE RESIDENTIAL PART 46,73 M2
- / A USABLE AREA OF THE ROOF 17 M2
- / UP TO 12 PEOPLE

THE HOUSE IS BUOYANT BY VERY SAFE POLYETHYLENE FLOATS
WITH LOW DRAFT. THE STEEL CONSTRUCTION
OF A HOUSEBOAT IS INSULATED WITH XPS INSULATION.

EQUIPMENT OPTIONS: SOLAR PANELS, WATER TANKS, WASTE
TANKS, FUEL TANKS, OUTBOARD MOTORS UP TO 2X60 KM AND
OTHERS.

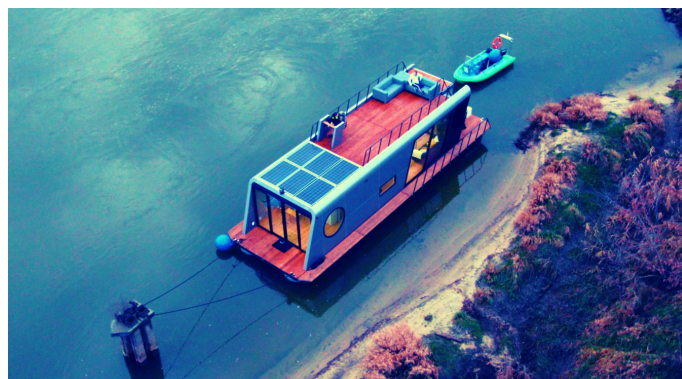

LEFT / FRONT SIDE VIEW

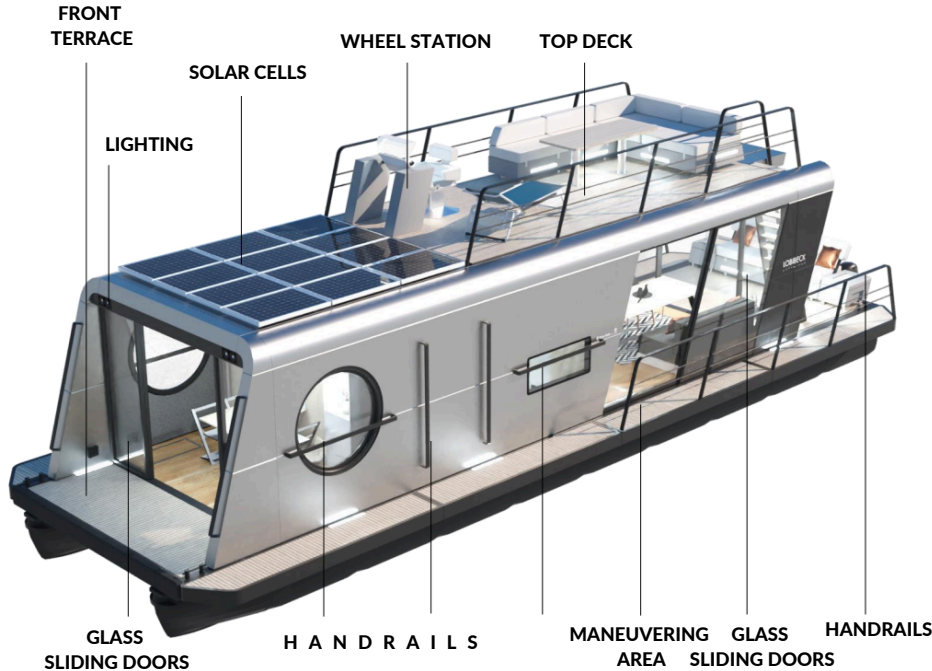

THE FRONT PART FITS A MULTIFUNCTIONAL CABIN WITH A WHEEL STATION, A LIVING ROOM THAT TRANSFORMS INTO A DOUBLE BEDROOM AND A SPACIOUS WARDROBE.

A BATHROOM AND AN ADDITIONAL BEDROOM ARE LOCATED IN THE MIDDLE PART OF THE HOUSEBOAT. THAT PART ALSO CONTAINS TECHNICAL INSTALLATIONS AND ADDITIONAL STORAGE SPACES. THE BOW PART OF THE UNIT HAS BEEN DESIGNED TO PROVIDE A WHOLE RANGE OF FUNCTIONAL SOLUTIONS SUCH US LIVING ROOM, DINING ROOM, AND ADDITIONAL BEDROOM.

RIGHT / AFT SIDE VIEW

THE AFT PART INCLUDES A LIVING ROOM CONNECTED TO THE AFT TERRACE, THE NATURAL "EXTENSION" OF THE LIVING SPACE AND RECREATIONAL TERRACE COVERING OVER 2/3 OF THE ROOF AREA. THE AFT PART HAS BEEN DESIGNED TO MAXIMIZE CONTACT WITH THE ENVIRONMENT - NATURE AND LANDSCAPE. THREE LARGE GLASS WALLS CAN BE OPENED, ENLARGING THE SPACE OF THE LIVING ROOM WITH AN ADDITIONAL AREA OF THE AFT TERRACE AND HALF DECKS.

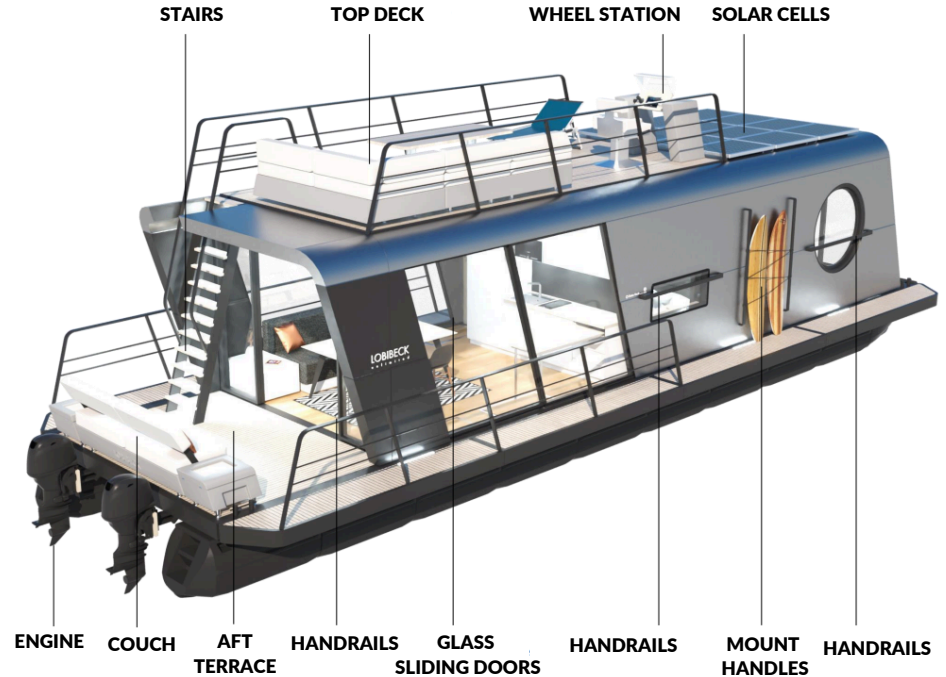

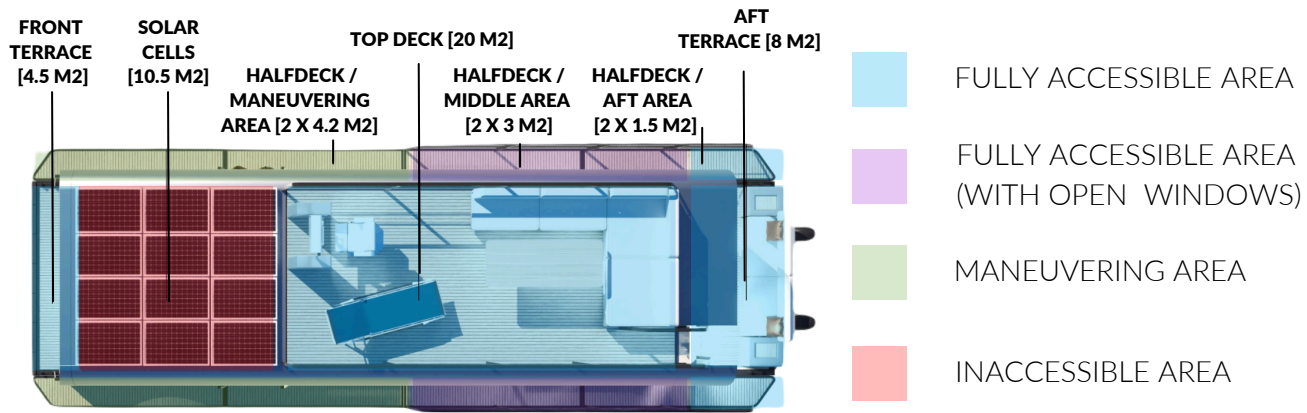

ON THE TOP DECK, A USABLE AREA REDUCED BY THE PHOTOVOLTAIC PANELS IS LOCATED. THE COMBINED SPACE OF THE TERRACES [32.5M2] MAKES A LARGE, FULLY ACCESSIBLE AREA. THE HALF-DECK AREA IS ALSO AVAILABLE IN 100%, BUT ITS USEFULNESS INCREASES FROM THE AFT - AS AN EXTENSION OF THE AFT TERRACE, ENLARGEMENT OF THE LIVING ROOM AFTER OPENING THE WINDOWS TO THE HALF-DECKS USED IN MANEUVERING SITUATIONS.

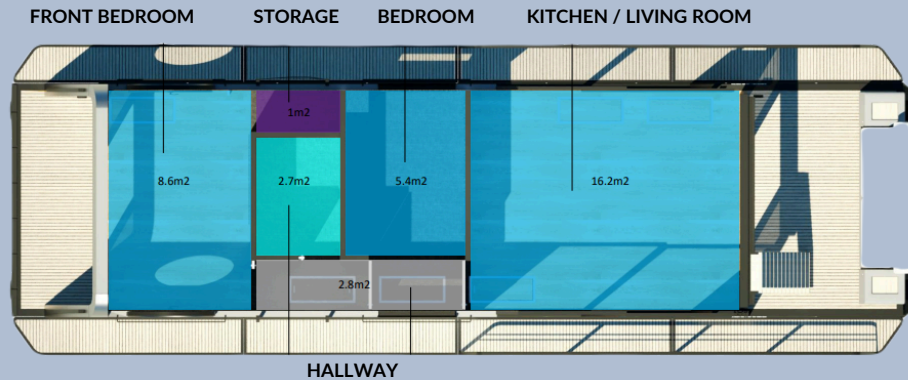

NIGHT

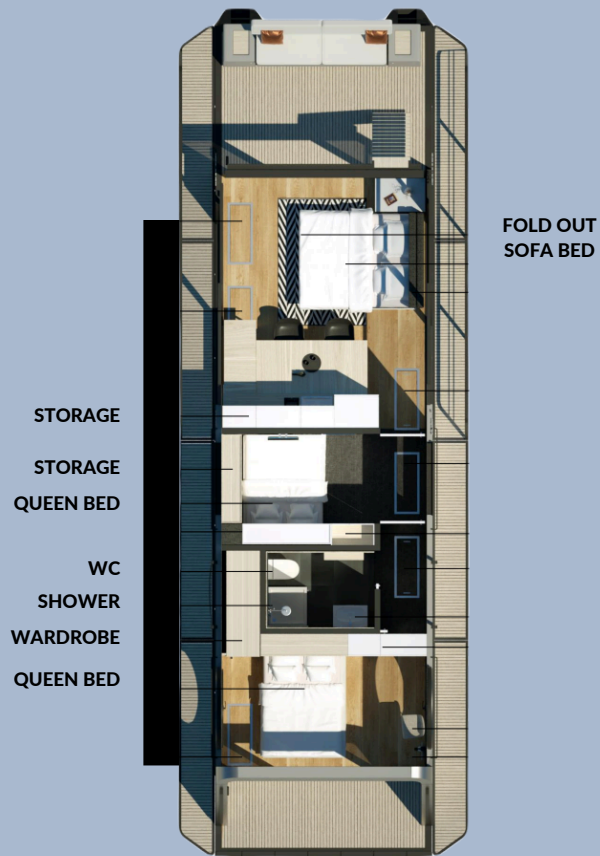

DAY

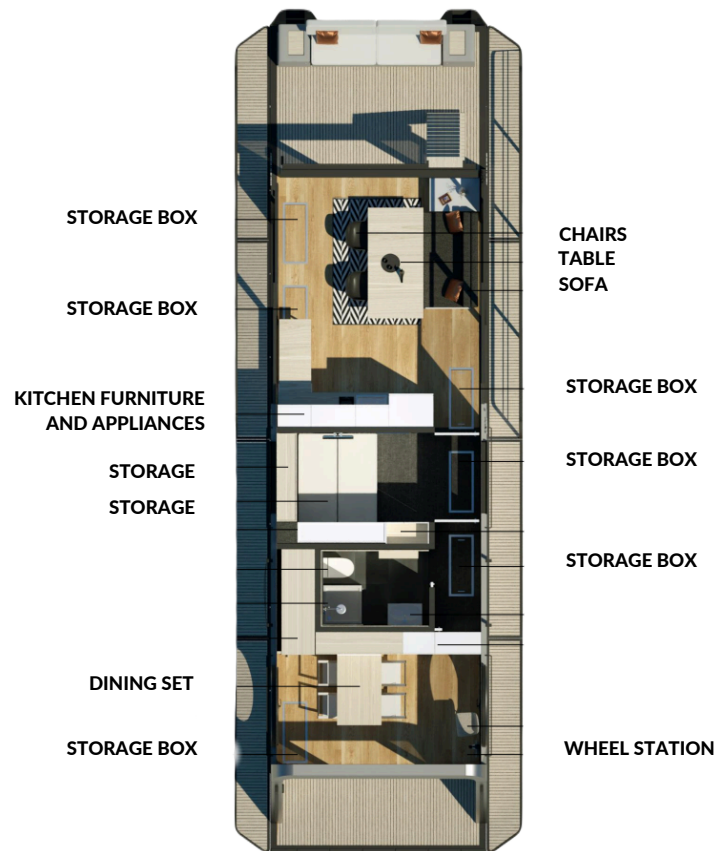

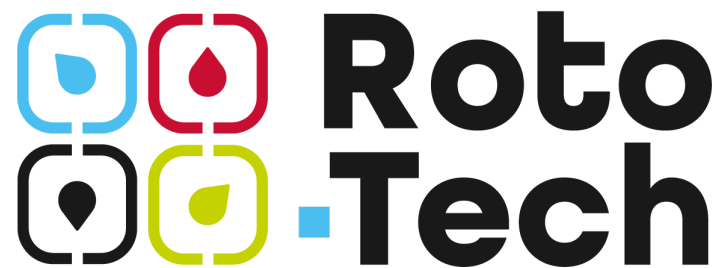

SYMMETRIA SP. Z O.O.

TEL.: +48 602-584-899

TEL.: +48 662-231-555

E-MAIL: EXPORT@SYMMETRIA.COM.PL

WWW.ROTO-TECH.ORG



@ROTOTECHRECREATION



ROTOTECHPL

BUSINESS ADDRESS

**PRZEMYSŁOWA 3
05-650 CHYNOW, PL**

ADRES REJESTROWY

**ZGODA 5/8
00-018 WARSZAWA**